

**PLAN**  
SCALE 1/2"=1'-0"

- CONCRETE CAP TO BE SET ON TOP OF BLOCK FOUNDATION.
- FILL CENTER OF STATUE BASE WITH COMPACTED SAND.
- INSTALL 6X6 WIRE MESH IN CONCRETE CAP.

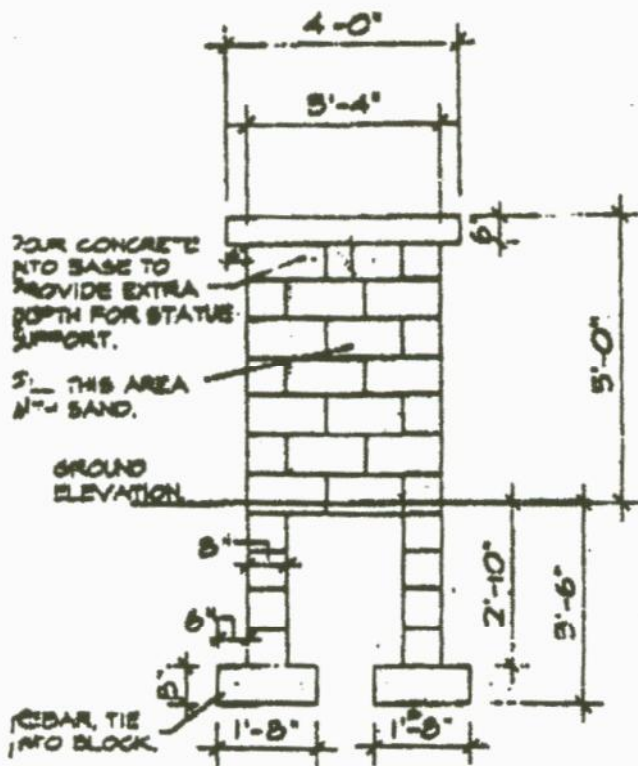

**SECTION AA**  
SCALE 1/2"=1'-0"

- USE STANDARD CONCRETE BLOCK FOR STATUE BASE.
- PROVIDE FOR WEEP HOLES AT BOTTOM OF BLOCK BASE TO ALLOW ANY MOISTURE TO DRAIN.
- FOOTING TO EXTEND BELOW LOCAL FROST LINE.
- CONTACT LOCAL CONCRETE SUPPLIER FOR RECOMM. AS TO CONCRETE STRENGTH FOR THIS TYPE OF CONSTRUCTION.
- CONCRETE FOOTING SHOULD CONTAIN REBAR AND SHOULD EXTEND UP INTO BLOCK.
- FILL CENTER OF PEDESTAL WITH MORTAR SAND TO WITHIN 6" OF TOP; FILL THE REST OF VOID WITH CONCRETE WHEN CAP IS POURED.

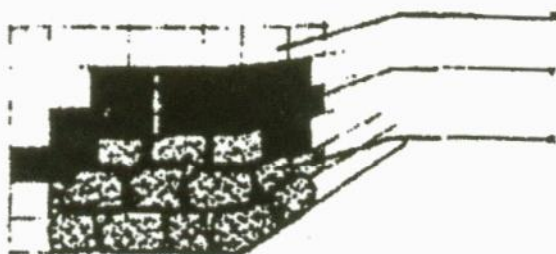

CONCRETE BLOCK BASE

MORTAR BED

CULTURED FIELD STONE

NOTE: HESBRY CONCRETE CUT OF HOUGHTON LAKE IS A SUPPLIER OF CULTURED FIELD STONE.

**CULTURED STONE**  
NOT TO SCALE